

- GENERAL**
1. ALL WORK TO COMPLY WITH THE NATIONAL BUILDING REGULATIONS
 2. ALL DIMENSIONS AND LEVELS TO BE CHECKED ON SITE BEFORE ANY WORK COMMENCES
 3. THIS DRAWING IS NOT TO BE SCALED AND ONLY DIMENSIONS ARE TO BE USED
 4. SHOULD ANY DISCREPANCIES BE NOTED ON THIS DRAWING, PLEASE NOTIFY M&T COMMERCIAL PRIOR TO WORK COMMENCING
 5. VERTICAL D.P.C. TO ALL CHANGES IN FLOOR LEVELS
 6. ALL LEVELS, UNLESS OTHERWISE INDICATED, ARE FINISHED FLOOR LEVELS
 7. FINISHED FLOOR LEVELS ARE TO BE A MINIMUM OF 150MM ABOVE NATURAL GROUND LEVEL
 8. ALL GLAZING TO COMPLY WITH "PART N" OF THE NATIONAL BUILDING REGULATIONS

- DRAINAGE**
1. Ø100MM PVC SOIL PIPES TO MIN. 1:60 FALL TO EXTERNAL Ø150MM DRAIN CONNECTED TO MUNICIPAL CONNECTION POINT
 2. Ø100MM CAST IRON CVP AT ONE BEFORE HEAD OF DRAIN TO MIN. OF 1800MM RISE ABOVE WINDOW SILL/DECK
 3. SOIL PIPE DROPPERS TO BE Ø100MM CAST IRON
 4. IE & WE'S AT ALL BENDS & JUNCTIONS TO HAVE CLEARLY MARKED COVERS AT GROUND LEVEL
 5. ALL WASTE PIPES TO BE SURFACE MOUNTED
 6. ALL WASTE & SOIL PIPES LOCATED UNDER SURFACE BEDS TO BE ENCASED IN 230MM CONCRETE ALL ROUND
 7. NO BENDS OR JUNCTIONS IN EITHER SOIL OR WASTE PIPES TO TAKE PLACE UNDER SURFACE BEDS
 8. DROP IN LEVEL EXCEEDING 1200MM TO BE PROVIDED WITH Ø100MM A.S. VENT PIPES
 9. DOWN SOIL PIPE VENTS & WASTE PIPES TO BE PROVIDED WHERE REQUIRED BY REGULATIONS

- LIGHTING & VENTILATION**
1. AREAS WILL BE EITHER AIR-CONDITIONED OR MECHANICALLY VENTILATED TO A.C. ENGINEER'S DESIGN AND SUPERVISION IN ACCORDANCE WITH "PART O" OF THE N.B.R. AND THE HEALTH ACT (63 OF 1977)
 2. HABITABLE ROOMS WITH NO ARTIFICIAL VENTILATION TO BE PROVIDED WITH WINDOWS OF NO LESS THAN 10% IN THE AREA SERVED WITH A MIN. OPENING OF 5% OF THE FLOOR AREA

- SPACE HEATING**
1. SPACE HEATING IS TO BE INCORPORATED IN THE AIR-CONDITIONING SYSTEM TO A.C. ENGINEER'S DESIGN
 2. ROOF INSULATION AS PER SPEC. TO BE LAID OVER RAFTERS AND BATTENS

- GLAZING**
1. THE NORMAL THICKNESS OF A PANEL OF GLASS WILL NOT BE LESS THAN THAT INDICATED IN THE FOLLOWING TABLE:

| GLASS THICKNESS (MM) | MAX. AREA OF PANEL (M ²) |
|----------------------|--------------------------------------|
| 3 | 0.75 |
| 4 | 1.5 |
| 5 | 2.1 |
| 6 | 3.2 |

2. GLAZING TO DOORS TO BE 6MM SAFETY GLASS OR SIMILAR
3. GLAZING NOT APPARENT APPROACHING PERSONS SHALL BEAR DISTINCTIVE MARKING TO RENDER GLAZING MORE APPARENT
4. ALL GLAZING TO BE INSTALLED IN ACCORDANCE WITH SABS 0137 AND SABS 1263

- FIRE**
1. FIRE DESIGN TO CONFORM TO SPECIALIST FIRE CONSULTANT PROPOSALS

| REV | DATE | DESCRIPTION | DRAWN | CHECKED |
|-----|------|-------------|-------|---------|
| 01 | | | | |

TENANT SIGNATURE: _____
 LANDLORD SIGNATURE: _____

LOCATION FIGURE



CLIENT
ICASA

PROJECT
ECO POINT OFFICE PARK BLOCK C

DRAWING
TENANT INSTALLATION OFFICE LAYOUT MEZZANINE FLOOR

CONSULTANT



PO Box 98727
 Fairre Glen
 0046
 The Board Walk
 Block 5
 Haymarket Street
 Pretoria
 Tel: (012) 991 0700
 Fax: (012) 991 4402
 Web: www.m-t.co.za
 Email: info@mtddevelopment.co.za

DRAWING NUMBER **223**

COUNCIL REF. NO.

SCALE DATE STATUS DRAWN REV
1:200 20/07/2018 R PP -

STATUS: I = INFORMATION / C = CONSTRUCTION / R = RECORD

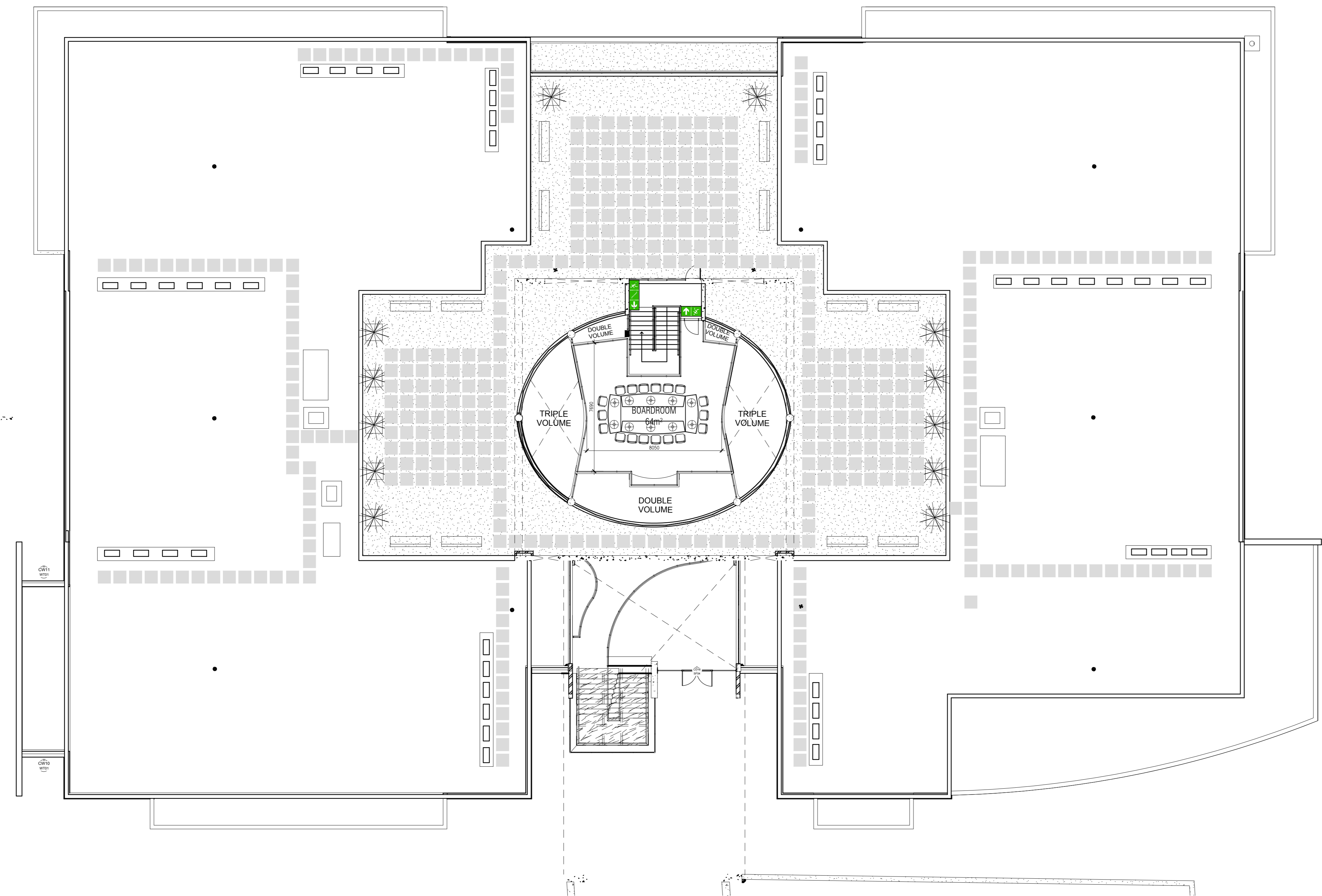

1 TENANT INSTALLATION
 223 1:200 MEZZANINE FLOOR